

KBR 315D2 IE3 THERMO FAN

Item no. 87914

Document type: **Product card**
 Document date: **2019-07-16**
 Generated by: **Systemair Online Catalogue**

Description

- Max temperature of transported air 120°C
- Speed-controllable(exept models 280D2 & 280D2-4)
- Integral thermal contacts
- Low sound level

The KBR fans have impellers manufactured from aluminum with backward-curved blades and external rotor motors. The KBR casing is manufactured from doubleskinned galvanised sheet steel and is insulated with 50 mm mineral wool.

The KBR fans have a swing-out door for easy inspection and service. The direction of the door opening can easily be changed from left to right at site. The fan is isolated from the casing via connectors and anti-vibration dampers are incorporated into the base frame.

To protect the motors from overheating the KBR fans have integral thermal contacts(KBR 280D2 & 280D2-4 with PTC) with external leads for connection to a motor protection device.

Please note: Speed control by voltage, i.e. voltage transformers, is not possible!

In accordance with Commission Regulation (EC) no 640/2009 of the European Parliament - eco-design requirements for electric motors - the new international efficiency classes are binding as of 16 June 2011. These guidelines defined by CEMEP and EPACT are regarded as international standard for energy-saving high-efficiency motors for frequencies of 50 or 60 Hz and make the use of IE2 motors mandatory.

With this new and more efficient technology we offer our customers many advantages such as environmentally friendly operation, reduced energy consumption and hence lower emissions. IE3 motors have a higher efficiency even in part load operation and allow optimum adjustment to the operating point. In addition, the IE3 motors generate less noise and develop less heat, which has a positive influence on the efficiency and the cooling requirement of the motor. Please note: IE3 motors cannot be speed controlled by voltage, i.e. voltage transformers.



Technical parameters

| Nominal data | | |
|-------------------------------------|------|--------|
| Voltage | 400 | V |
| Frequency | 50 | Hz |
| Phase | 3 | ~ |
| Input power (P1) | 1212 | W |
| Current | 2,18 | A |
| Max. airflow | 1,14 | m³/s |
| R.p.m. | 2945 | r.p.m. |
| Weight | 63,6 | kg |
| Temperature data | | |
| Max. temperature of transported air | 120 | °C |
| Sound data | | |
| Sound pressure level at 4 m | 50 | dB(A) |
| Sound pressure level at 10 m | 42 | dB(A) |
| Protection / Classification | | |
| Insulation class | F | |
| Enclosure class, motor | IP55 | |

Diagrams

Diagrams

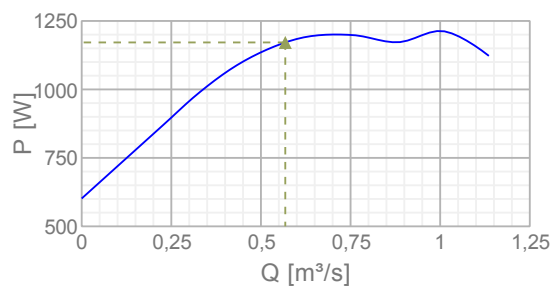
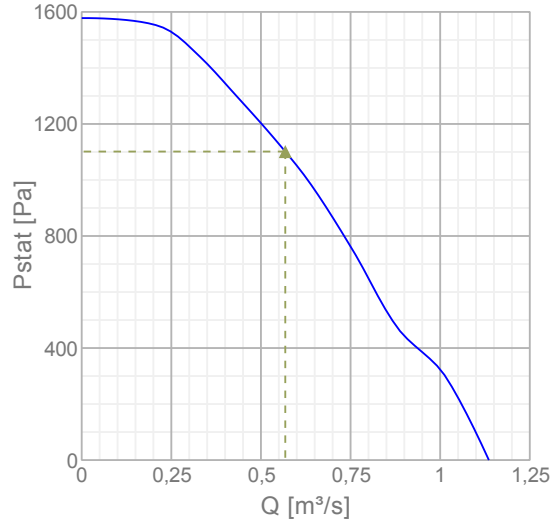

Max efficiency

| Hydraulic data | | | | | | | | | | |
|---------------------------|-------|----|-----|-----|-----|----|----|----|----|--------------|
| ▲ Working air flow | | | | | | | | | | 0,568 m³/s |
| ▲ Working static pressure | | | | | | | | | | 1101 Pa |
| ▲ Power | | | | | | | | | | 1172 W |
| Speed | | | | | | | | | | 2944 r.p.m. |
| Current | | | | | | | | | | 2,14 A |
| SFP | | | | | | | | | | 2,06 W/(l/s) |
| Voltage | | | | | | | | | | 400 V |
| Sound power level | | 63 | 125 | 250 | 500 | 1k | 2k | 4k | 8k | Tot |
| Inlet | dB(A) | 44 | 57 | 67 | 75 | 73 | 71 | 65 | 57 | 79 |
| Outlet | dB(A) | 45 | 59 | 68 | 76 | 74 | 73 | 66 | 59 | 80 |

Dimensions

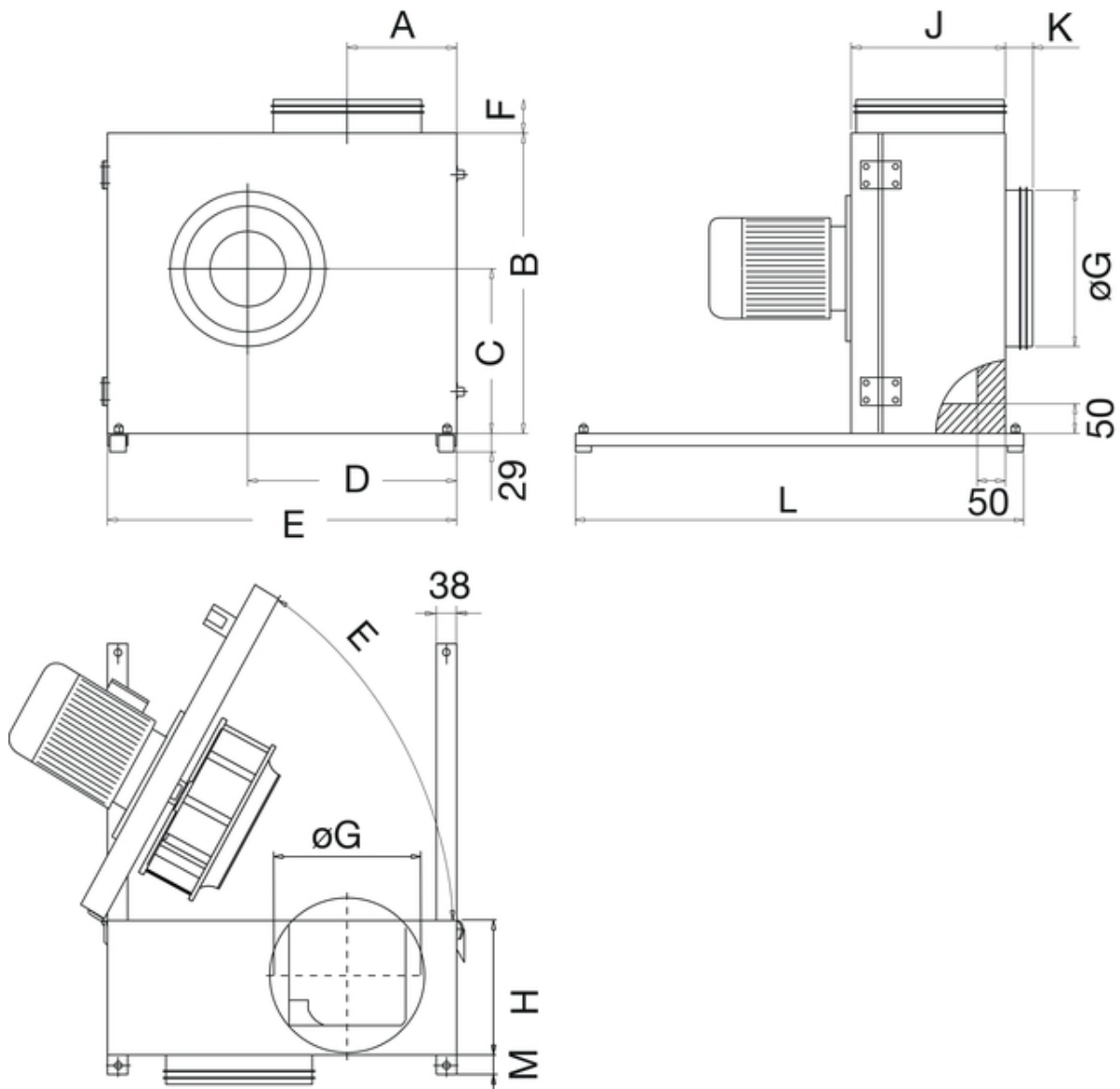

| KBR | A | B | C | D | E | F | øG | H | J | K | L | M |
|-----|-------|-----|-----|-----|-----|-----|-----|-----|-----|----|-----|----|
| 315 | 187,5 | 600 | 339 | 398 | 690 | 125 | 315 | 249 | 307 | 70 | 770 | 55 |

Wiring

Dreiphasenmotor mit Kaltleiter Three phase motor with cold conductor Moteur triphasé avec résistance PTC

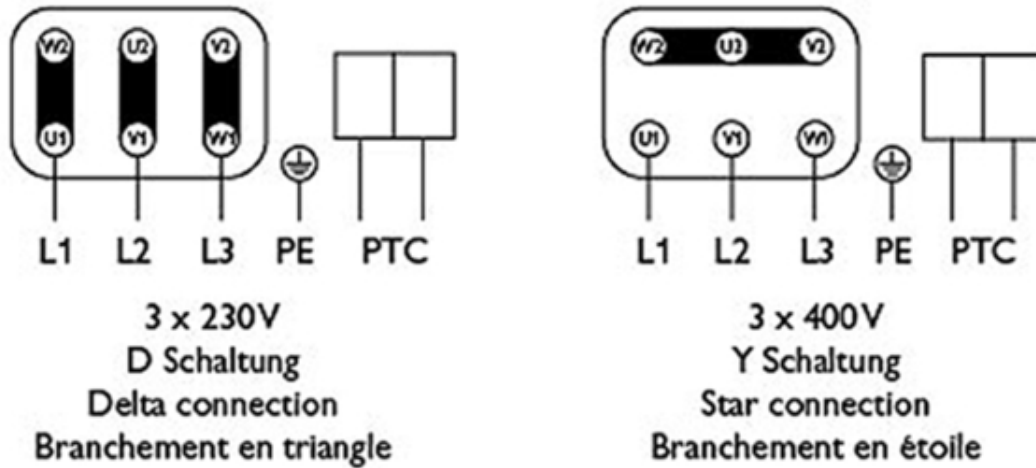

Drehrichtungsänderung durch Vertauschen von 2 Phasen
Changing of direction of rotation by interchanging of two phases
Changement de sens de rotation par inversion de deux phases

Typenschild beachten! See label! Voir plaquette!

Accessories

Electric accessories

- [Trigger unit U-EK230E \(30199\)](#)
- [REV-5POL/05 ON/OFF \(33979\)](#)
- [REV-9POL/12 ON/OFF \(33981\)](#)
- [REV-5POL/05 incl. EMC KIT \(34549\)](#)
- [FRQ-4A V2 \(36227\)](#)
- [FRQ5-4A+LED V2 \(36229\)](#)
- [FRQ5S-4A+LED V2 \(36233\)](#)
- [FRQS-4A V2 \(36231\)](#)

Accessories

- [ASF 315/KB Flex. connection \(2718\)](#)
- [WBK 315/355 Wall bracket \(2721\)](#)
- [ALS-KBR drain plug \(2727\)](#)
- [WSD KBR-2 Weather roof f. motor \(2729\)](#)

Documentation

 [manual_kbr_en_\[003\].pdf \(3,41MB\)](#)

 [eu declaration of conformity_thermofans_en_\[002\].pdf \(46,39kB\)](#)

Specification text